

WEST VIRGINIA HISTORIC PROPERTY INVENTORY FORM

Street Address N side Middleway Pike on W side Piedmont Lane	Common/Historic Property Name/ Both St. George's Chapel (ruins)	Field Survey # Jefferson County 2004- 2005 Survey No. 316	Site # (SHPO Only)
Town or Community vic. Charles Town	County Jefferson	Negative No. Jefferson County 2004-2005 Survey Roll 28, Negative 15	NR Listed Date 8/7/2001
Architect/Builder unidentified	Date of Construction 1769	Style no style	
Exterior Siding/Materials limestone	Roofing Material n/a	Foundation stone	
Property Use or Function Residence Commercial Other <input checked="" type="checkbox"/> religious [ruins]	UTM # 18/250586/5353260		
Survey Organization & Date Taylor & Taylor Associates, for the Jefferson County Historic Landmarks Commis- sion, 2004-2005	Quadrangle Name Middleway, WV Part of What Survey/FR# Jefferson County 2004-2005 Survey		

Sketch Map of Property
or Attach Copy of USGS Map

See Survey Report



Present Owners	Owner's Mailing Address		
Phone #			
Describe Setting	<u>± 1</u>	Acres	
This property is located in rural Jefferson County, west of the county seat of Charles Town.			
	<u> </u> Archaeological Artifacts Present		
Description of Buildings or Site (Original and Present)	<u>n/a</u>	Stories	<u>n/a</u> Front Bays
This property consists of the ruins of an eighteenth-century limestone church.			
<i>(Use Continuation Sheets)</i>			
Alterations	<input type="checkbox"/> Yes	<input type="checkbox"/> No	If yes, describe
Additions	<input type="checkbox"/> Yes	<input type="checkbox"/> No	If yes, describe
Describe All Outbuildings			
none			
<i>(Use Continuation Sheets)</i>			
Statement of Significance			
These ruins were once Norborne Church so named to honor the eighteenth-century Royal Governor, Norborne Berkeley, Lord Botetourt. The parish was organized in Winchester in 1771 and Robert Worthington donated the land for the church; Samuel Washington of Harewood, located c. one-half mile to the west, was senior warden. Growth of the Charles Town area spurred the decline of the church and the property eventually was sold to Abraham Davenport of "Altona." The property was recorded by the Historic American Building Survey in 1937; two of the HABS photos and one of the drawings are reproduced on Continuation Sheets.			
<i>(Use Continuation Sheets)</i>			
Bibliographical References			
Hulse, Charles, "Archaeological Investigations at St. George's Chapel, Jefferson County, West Virginia." Shepherd College Cultural Resource Management Report No. 48, 2000.			
Also see Survey Report			
<i>(Use Continuation Sheets)</i>			
Form Prepared By:		Date: January, 2005	
Name/Organization: David L. Taylor, Principal, Taylor & Taylor Associates, Inc.			
Address: 9 Walnut Street			
Brookville, PA 15825			
Phone #: 814-849-4900 e-mail: taylorandtaylorinc@adelphia.net			

West Virginia Division of Culture and History
State Historic Preservation Office

WEST VIRGINIA HISTORIC PROPERTY FORM
CONTINUATION SHEET

NAME St. George's Chapel Ruins

SITE # Jefferson County 2004-2005 Survey No. 316

RUINS OF ST. GEORGE'S CHAPL.

HABS
W. 110
19-CHART. 4
2.

Owner: Col. H. B. Eatonport

Date of Erection: Unknown

Builder: Unknown

Present Condition: In ruins, only parts of walls standing.

Number of Stories: Two

Materials of Construction:

Built of native limestone. Miss Susan Gregg Gibbon in an article from the magazine of the Jefferson County Historical Society, Dec. 1936 states that the woodwork was of cedar, the floors of tile and the roof of copper.

Other Existing Records:

Robert Worthington was the original owner of the tract of land on which St. George's Chapel now stands. He obtained a tract of 5,000 acres by patent in 1734. On this land his son Robert Worthington, Jr. built Piedmont in 1736. In 1770 Piedmont Plantation was purchased by a Mr. Nourse and from this owner was taken land for the church. As the Briscoes bought Piedmont from Nourse in 1780, the church was erected sometime between the dates of 1770 and 1780.

In 1769 an order was given for the division of the original parish [then consisting of all that is now Shenandoah, Page, Warren, Clarke, Frederick, Berkeley, Hampshire and Jefferson Counties] into three, namely, Beckford, Berkeley and Norborne. Jefferson County came under the Norborne Parish and was so named in honor of Norborne Berkeley, Baron de Botetourt, who was governor of the colony of Virginia from 1760 to 1770.

References: History of the Lower Shenandoah Valley- Morris.

Shelby W. Tucker & Biggs

WEST VIRGINIA HISTORIC PROPERTY FORM CONTINUATION SHEET

NAME St. George's Chapel Ruins

SITE # Jefferson County 2004-2005 Survey No. 316

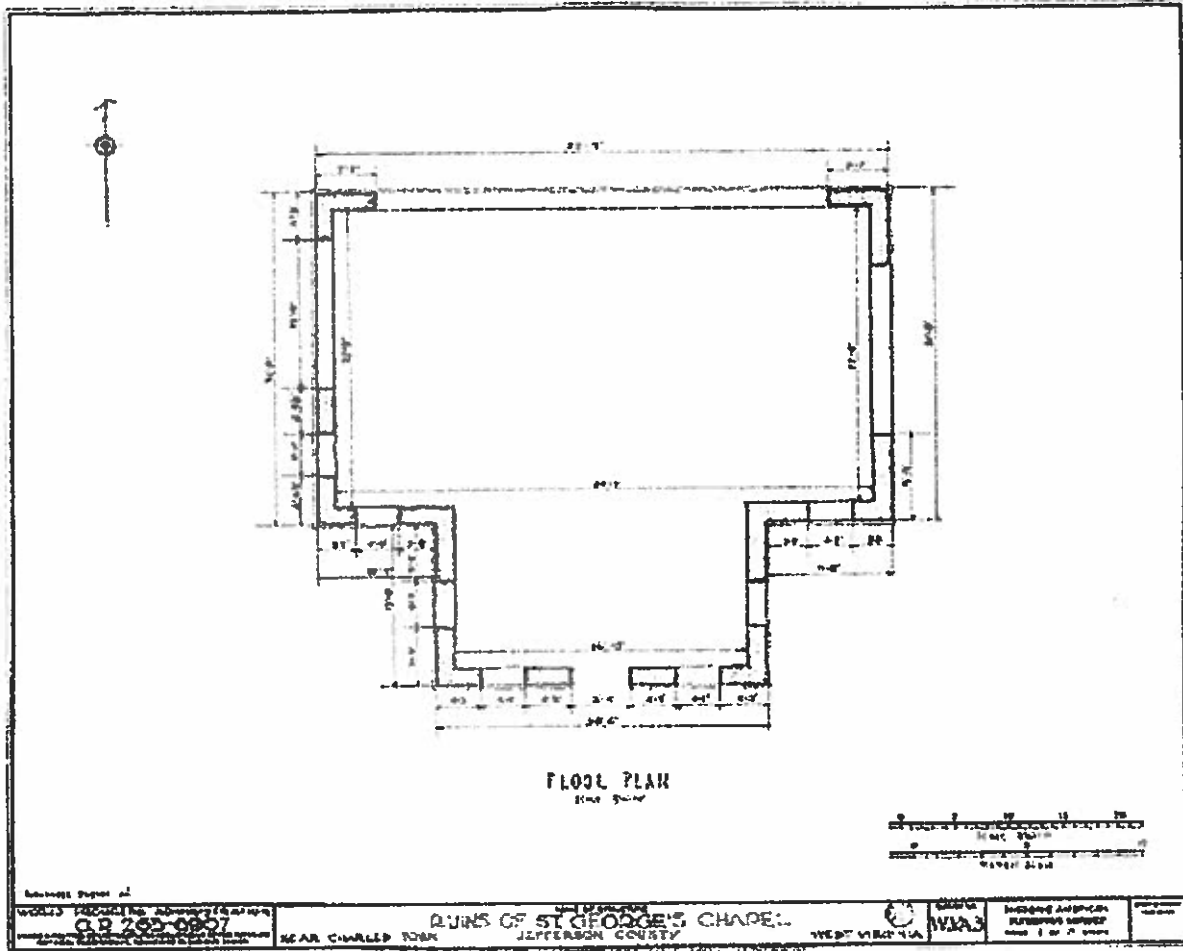

Floor plan, one of several 1937 HABS drawings of subject property

**WEST VIRGINIA HISTORIC PROPERTY FORM
CONTINUATION SHEET**

NAME St. George's Chapel Ruins

SITE # Jefferson County 2004-2005 Survey No. 316

2 of 4 HABS PHOTOS OF SUBJECT PROPERTY (1937)

